



FACILITY CONSTRUCTION BULLETIN No. 3940 ADDENDUM D2

Issued 3/3/2021

Prepared by the Port Authority Construction Management Division

Prepared By N. ALKHATIB/JPR

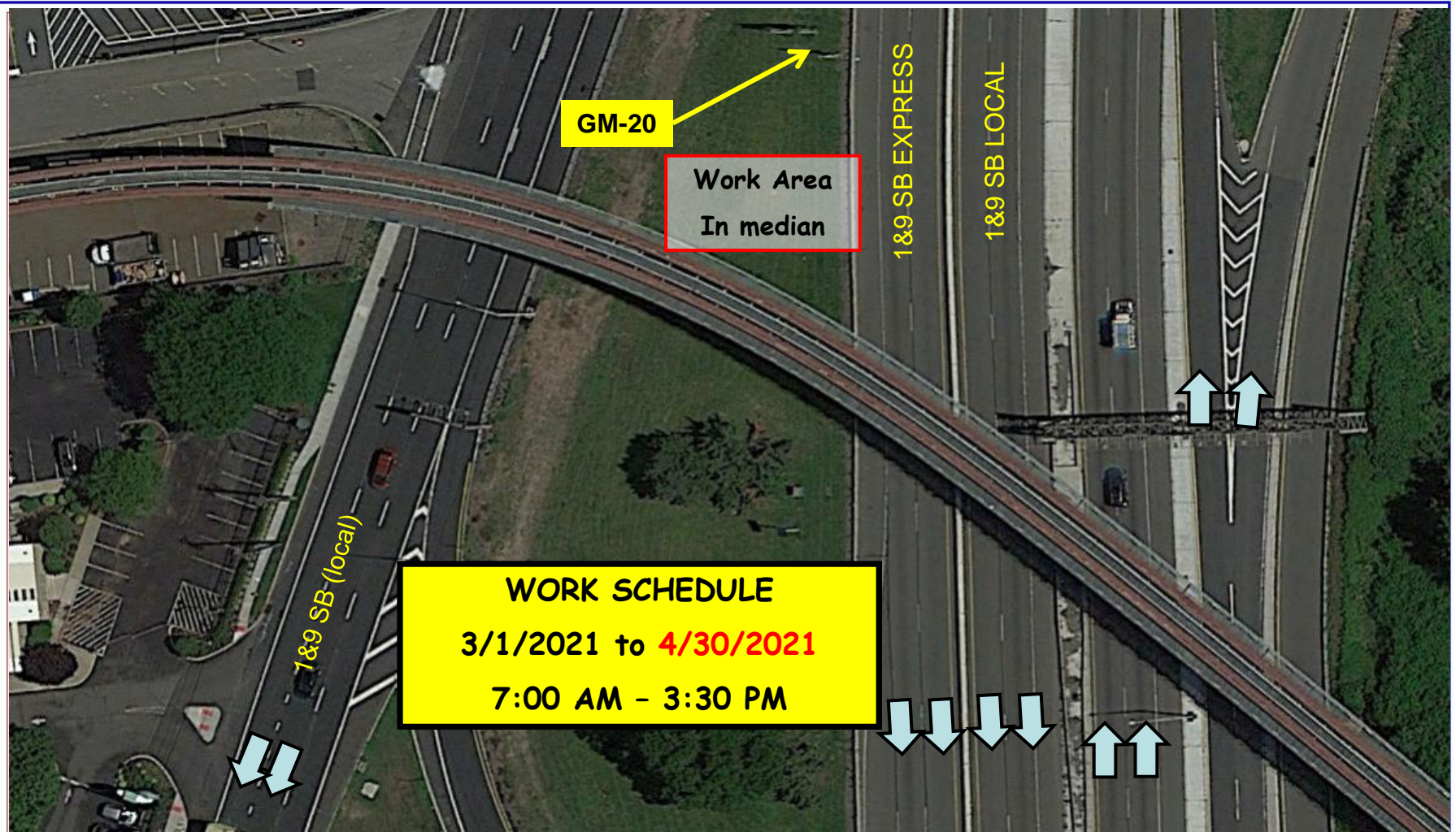

NEWARK LIBERTY INTERNATIONAL AIRPORT

3/3/2021

EWR 154.395

OVERHEAD SIGN STRUCTURE GM-20 ON-SITE DELIVERY AND ASSEMBLY OPERATION

On or about **Monday, March 1st, 2021** through **Friday, April 30th, 2021** from 7:00 AM to 3:30 PM contractor Conti Construction/J.F. Creamer sub will offload, stage and begin assembly of GM-20 in the grass median area behind guiderail. Equipment in use will not exceed a maximum boom height of 30 feet. All activities will be behind the guide rail in the grass median area. No lane closures will be required. Signs and PA Police will be on site.